

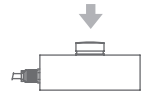

Capacity from 250 kg to 12500 kg

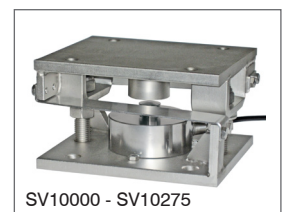

MOUNTING KITS



- 17-4 PH STAINLESS STEEL (on request AISI 420 stainless steel version; not OIML approved)
- COMBINED ERROR $\leq \pm 0.03\%$ (0.02% C3)
- PROTECTION CLASS IP68

CAPACITY	kg	ACCURACY CLASS	OIML	IECEX	Ex	EAC	NET WEIGHT OF LOAD CELL (kg)	CODE
250		-	-	•	•		1.1	SCBL250
500		-	-	•	•		1.1	SCBL500
1000		-	-	•	•		1.1	SCBL1000
2500		C2	C3	•	•		1.1	SCBL2500
5000		C2	C3	•	•		1.1	SCBL5000
7500		C2	C3	•	•		1.1	SCBL7500
10000		C2	C3	•	•		1.1	SCBL10000
12500		-	C3 *	•	•		1.6	SCBL12500

ON REQUEST

(*) Except for the capacity of 12500kg, which is already OIML R60 C3 approved

CERTIFICATIONS

OIML R60 C2 / C3 (see capacities table)

CERTIFICATIONS ON REQUEST

- Declaration of conformity + IP69K marking protection rating
Water protection when cleaning high pressure / steam jet (Test: pressurized hot water is sprayed from a distance of 150 mm).
Water pressure 100 bar; temperature 80 °C; test duration 250 seconds (Reference standard DIN 40050-9).
- Calibration report (ACCREDIA LAT traceability)
- ATEX II 1GD (zone 0-1-2-20-21-22)
- IECEx II 1GD (zone 0-1-2-20-21-22)
- OIML R60 C3 (see capacities table)
- Complies with the Eurasian Custom Union regulations (Russia, Belarus, Kazakhstan)

DIMENSIONS (mm)

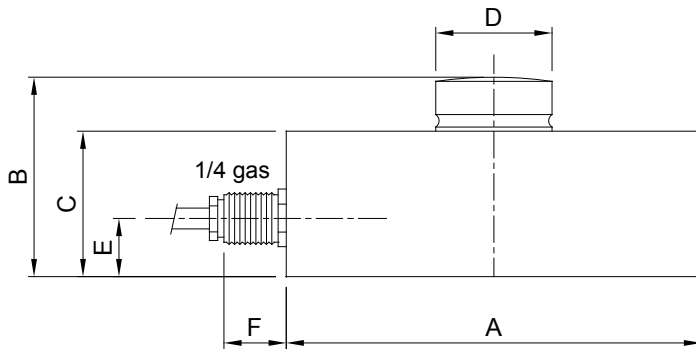

	250
kg	12500
A	Ø82
B	44
C	32
D	Ø22
E	14
F	15

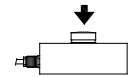

TECHNICAL FEATURES

Material	17-4 PH stainless steel		
OIML R60 Accuracy class • Verification intervals	-	C2 • 2000	C3 • 3000
Nominal load (E max)	250 - 500 - 1000	2500 - 5000 kg 7500 - 10000 kg	2500 - 5000 - 7500 kg 10000 - 12500 kg
Minimum verification interval (V min)	-	E max / 15000	
Combined error	≤ ±0.03%	≤ ±0.03%	≤ ±0.02%
Protection class	IP68		
Rated output	2 mV/V ±0.1%	Input resistance	700 Ω ±10
Temperature effect on zero	0.005% °C	Output resistance	700 Ω ±10
Temperature effect on span	0.003% °C	Zero balance	±1%
Compensated temperature range	-10 °C / +50 °C	Insulation resistance	>10000 MΩ
Operating temperature range	-20 °C / +70 °C	Safe overload (% of full scale)	150%
Creep at nominal load after 4 hours	0.03%	Ultimate overload (% of full scale)	300%
Max supply voltage without damage	15 V	Deflection at nominal load	0.4 mm

ELECTRICAL CONNECTIONS

Cable length	▲ 5 m (250-10000 kg) 10 m (12500-100000 kg)
Cable diameter	5 mm
Cores	4/6 x 0.25 mm ²

▲ On request: 10 m long cable version

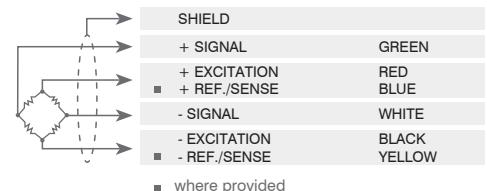

■ where provided